

# INSTALLATION INSTRUCTIONS

## SANDCRAFT BEADLOCK WHEELS



### TOOLS REQUIRED:

- Tire lube or soapy water & Rag
- Empty 5 gallon bucket
- 5/16" 12 pt socket
- Torque wrench
- Air compressor

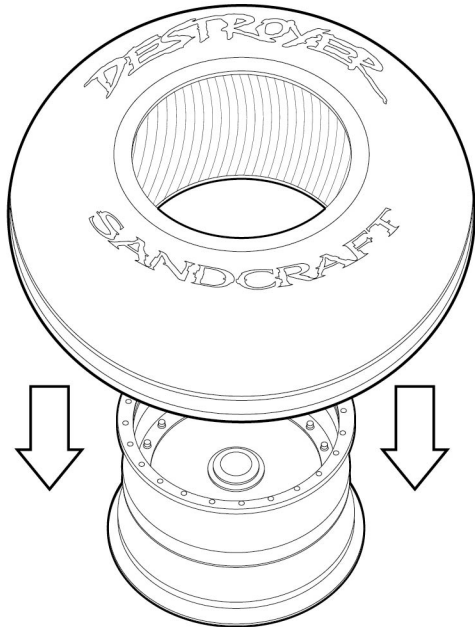

### STEP 1

Apply tire lube to the inside tire bead only. Do not lube the outside of the tire bead area.

### STEP 2

Place the wheel face down on a 5 gallon plastic bucket to raise it up off the ground and set the tire down onto the wheel until the inside bead seats on the wheel. Raising the wheel off the ground will allow the outside bead to sink down low enough to install the Beadlock ring.

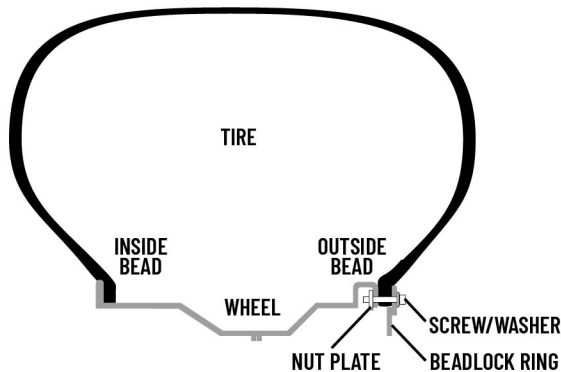

### STEP 3

Place the Beadlock ring on top of the tire bead. The wheel should be sitting beneath the tire bead with the tire bead and sandwiched between the wheel and the Beadlock ring. IMPORTANT: Ensure the tire is centered evenly on the wheel, if it isn't centered, you risk incomplete installation.

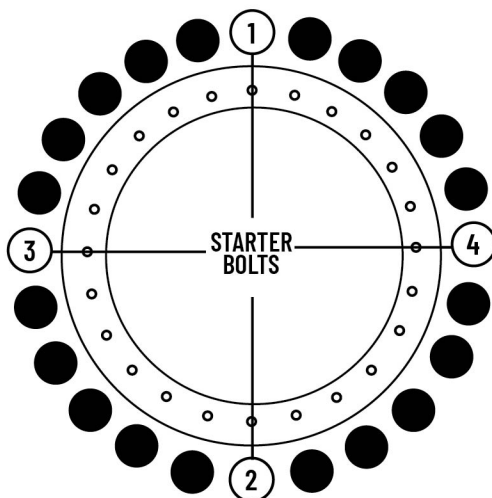

### STEP 4

Align the bolt holes between the two mounting surfaces. Depending on the thickness of your tire, you may need to press down on the ring to install the 4 supplied 1 1/4" silver starter bolts. These bolts are longer which makes it easier to seat the Beadlock ring.

# INSTALLATION INSTRUCTIONS

## SANDCRAFT BEADLOCK WHEELS

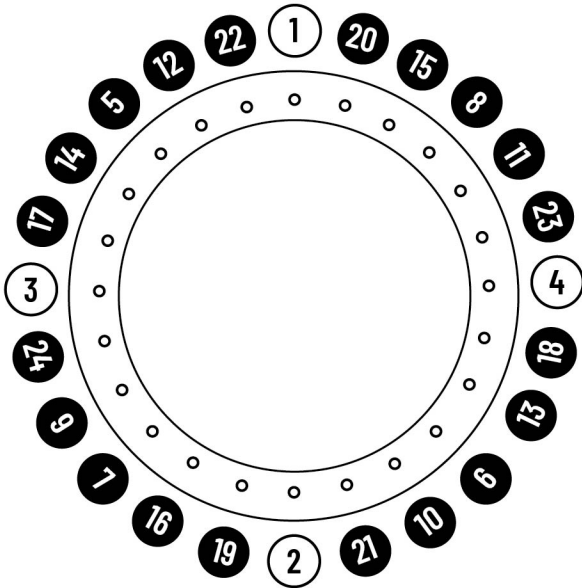

### STEP 5

Loosely install all the 7/8" 12 pt hardware. All hardware should be installed loosely by hand before tightening for proper installation.

### STEP 6

Carefully tighten the silver starter bolts in a cross pattern to ensure even seating of the Beadlock. Tighten the remaining 12 pt hardware in star pattern. Once seated, remove the starter bolts and replace with 12 pt hardware. Just seat the hardware on the first pass, once the entire Beadlock is seated, the hardware should be torqued to 10 ft/lbs. Finally, in a cross star pattern, torque the hardware to 15 ft/lbs. **IMPORTANT:** Each time you tighten one bolt, the bolts on either side will loosen. Double check all hardware before airing up the tire.

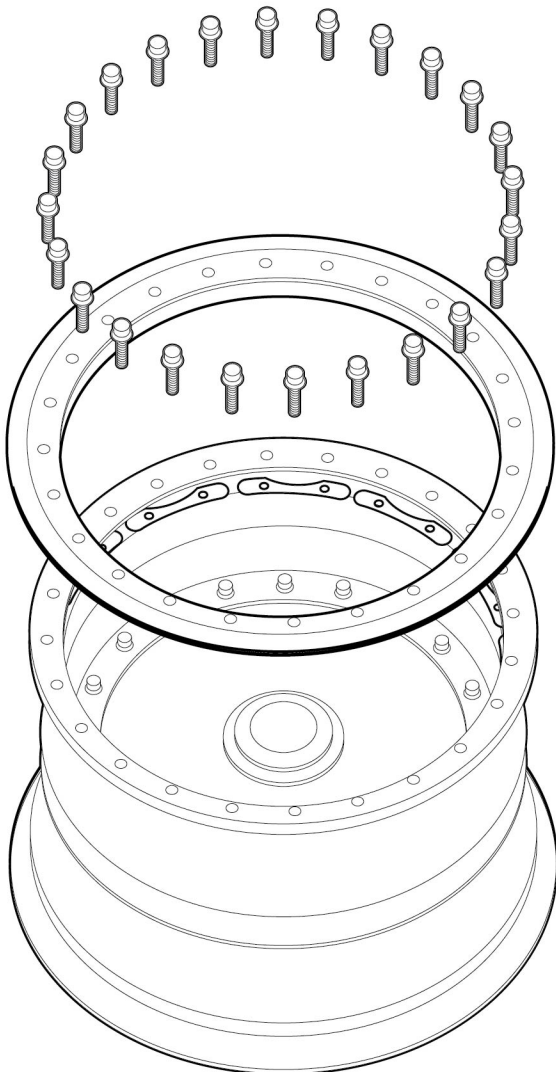

### STEP 7

Remove the tire from the bucket and place it face down on the floor. Inflate the tire to seat the inner bead while it is facing up. **DO NOT** exceed the manufacturers specifications for maximum air pressure. You may need to re apply tire lube to the inner bead at this point.

### STEP 8

Re check the torque on your hardware after the first ride and again at regular intervals to ensure proper seating. Even pressure and torque are critical to the correct operation of a beadlock wheel.